

Hydrotech[®] 785 Valve Carbon Filter Quick Set Up Manual

Step 1 – Inspection

Check to make sure you got everything supplied by factory and there is no visible or concealed damage. In case of missing items, please contact customer service immediately and have the Product Serial # handy. (Product Serial # can be found at the back of the control valve, see below)

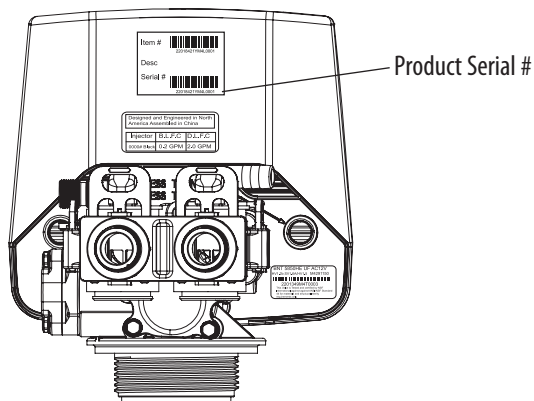

The items you will expect are:

1. Tank with Carbon Media loaded
2. Control Valve
3. Parts Kit

1. Tank with Softener Media loaded

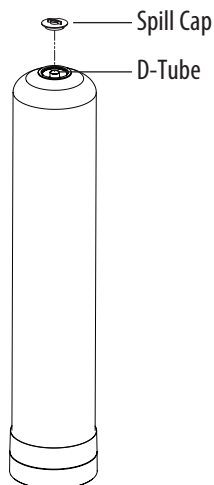

2. Control Valve

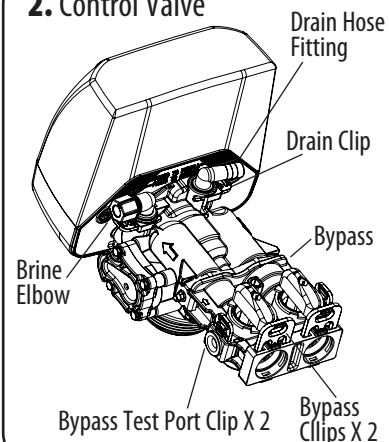

3. Parts Kit

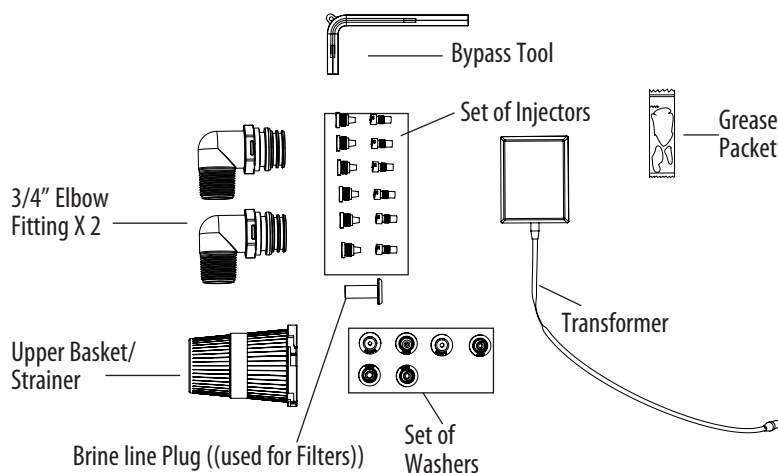

Grease port Orings using brush (not included) or your finger (Make sure to wear protective gloves)

Step 2 – Installing Valve to the Tank

Select a Installation location and make sure there is access to 110V power outlet and drain line. Lube the bottom Valve Orings with the grease supplied, Attach the Upper Basket. Unscrew the spill cap. Carefully Slide the D-Tube inside the Valve and Screw the Valve inside the Tank such that the power cord doesnt get caught between the valve and the tank. Make sure the D-Tube slides inside the valve.

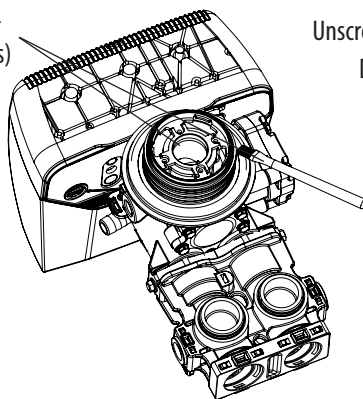

Unscrew Spill Cap
D-Tube

Attach Upper Basket

CAUTION: Make sure the power cord of the valve doesnt get caught between the threads

Step 3 – Install Drain Line Washer in the Valve

Swap this washer with the correct one

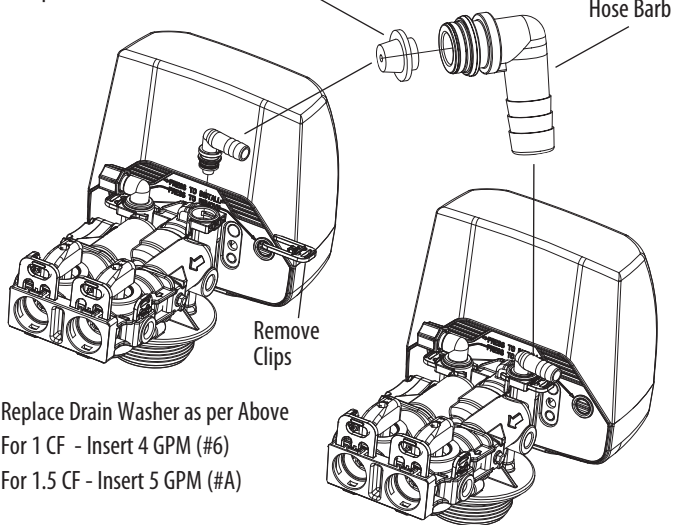

Replace Drain Washer as per Above
For 1 CF - Insert 4 GPM (#6)
For 1.5 CF - Insert 5 GPM (#A)

Step 4 – Plug Brine Line of the Valve

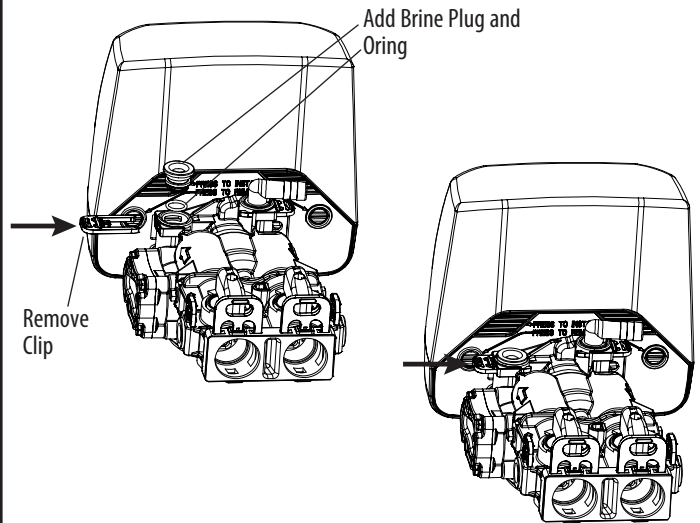

Step 5 – Power and Program Valve and Configure to Filter

Press **Up** and **Down** Button for 5 seconds

Select **B.W. Filter** using **Up/Down** Buttons- Press **Manual Regen** Button

Set **Backwash** to 10 minutes using **Up/Down** Buttons. Press **Manual Regen** Button

Set **Rinse** to 5 minutes using **Up/Down** Buttons. Press **Manual Regen** Button

Key Pad Setting

SETTINGS This function is to enter the basic set up information required at the time of installation.

MANUAL REGEN This function is to initiate an immediate or delayed manual regeneration.

DOWN / UP Increase or decrease the value of the settings while in the programming mode.

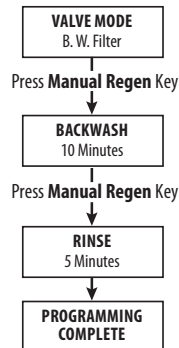
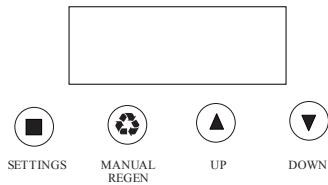

Step 6 – Set User Programming

Settings

Press **SETTINGS** key
(3 SECONDS / BEEP)
and use **Up/Down**
Buttons to Change the
Value

