

Hydrotech® 765 Valve Carbon Filter Quick Set Up Manual

Step 1 – Inspection

Check to make sure you got everything supplied by factory and there is no visible or concealed damage. In case of missing items, please contact customer service immediately and have the Product Serial # handy. (Product Serial # can be found at the back of the control valve, see below)

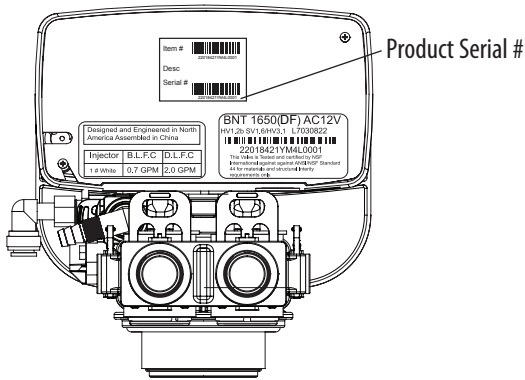

The items you will expect are:

1. Tank with Carbon Media loaded
2. Control Valve
3. Parts Kit

1. Tank with Carbon Media loaded

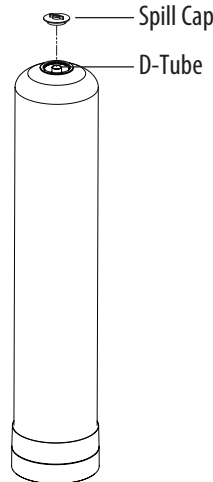

2. Control Valve

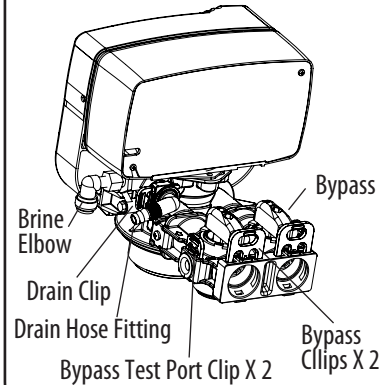

3. Parts Kit

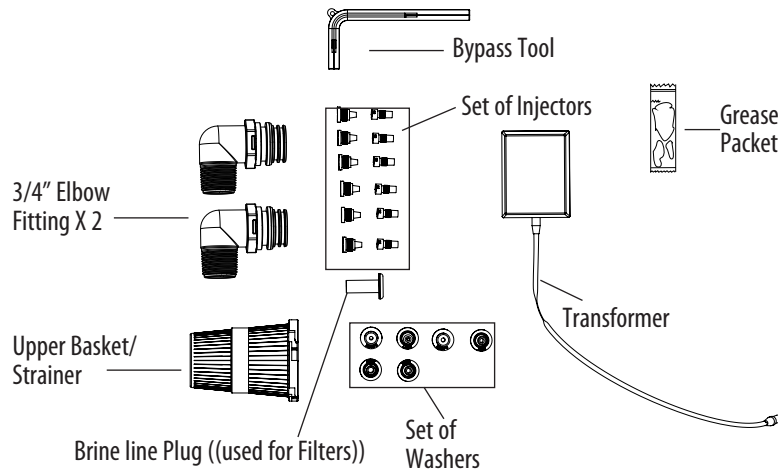

Grease port Orings using brush (not included) or your finger (Make sure to wear protective gloves)

Step 2 – Installing Valve to the Tank

Select a Installation location and make sure there is access to 110V power outlet and drain line. Lube the bottom Valve Orings with the grease supplied, Attach the Upper Basket. Unscrew the spill cap. Carefully Slide the D-Tube inside the Valve and Screw the Valve inside the Tank such that the power cord doesnt get caught between the valve and the tank

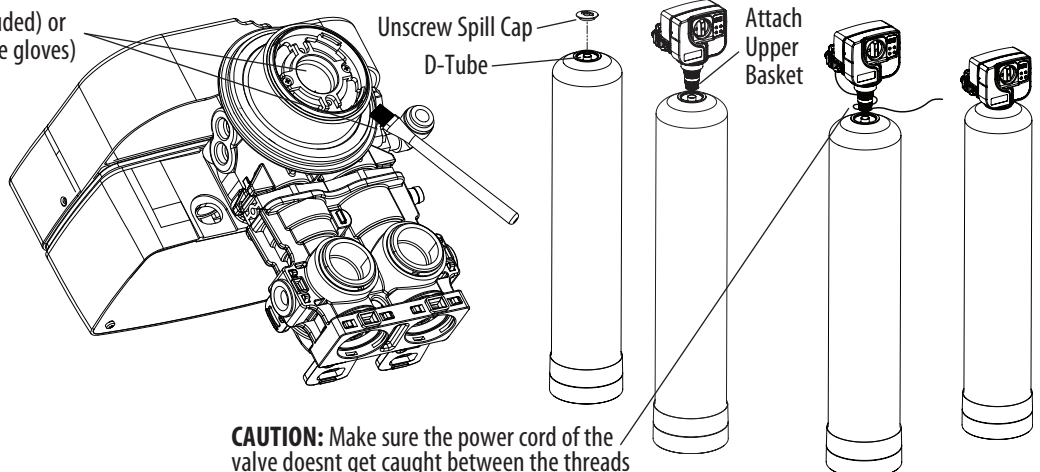

Step 3 – Attaching Brine Port Plug

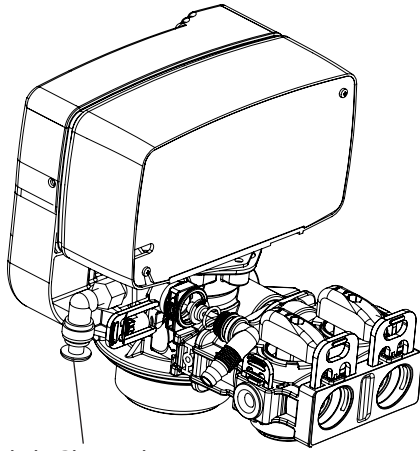

Push the Plug inside the Brine Elbow here

Step 4 – Change Drain Line Flow Washer

1. Remove the red clip as shown
2. Pull the drain elbow
3. Remove and Replace the washer as shown.

For 1 CF - use #5 (3.5 GPM)
For 1.5 CF - use #6 (4.0 GPM)

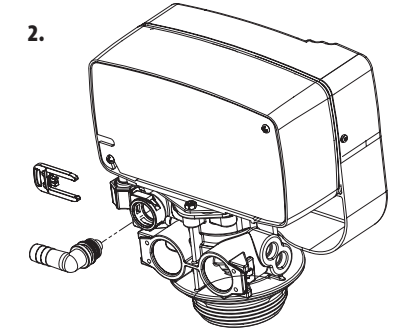
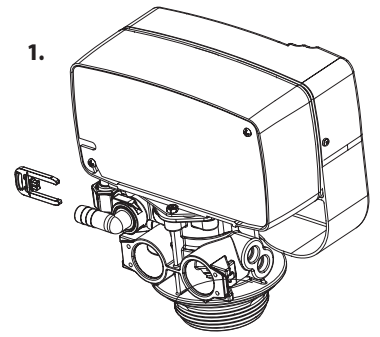
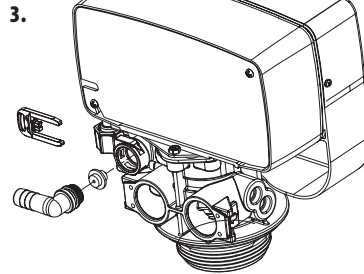

Step 5 – Power the Valve and Master Program to Filter Configuration

Attach the Transformer cable to the valve and plug in the transformer to the 110V Power outlet. you will notice the two screens on right will alternate.

TIME 08:27 AM REMAIN GAL 1060



KEYPAD

1. Hold **UP** and **DOWN** button for 5 seconds and Adjust Valve Type to “CALENDAR CLOCK”. **PRESS SELECT**
2. Adjust Regeneration Time. Press **UP** and **DOWN** key to quickly advance the hour and minutes. When desired time is displayed, press **SELECT** to Backwash
3. Adjust Backwash Time to 10 Minutes. **UP** and **DOWN** key to quickly change the minutes. When desired minutes press **SELECT** to Brine
4. Adjust Brine Time to 1 Minute. Press **UP** and **DOWN** key to quickly change the minutes. When desired minutes press **SELECT** to Rinse
5. Adjust Rinse Time to 10 Minutes. Press **UP** and **DOWN** key to quickly change the minutes. When desired minutes press **SELECT** to Refill
6. Adjust Refill Time to 0.0 Minutes. Press **UP** and **DOWN** key to quickly change the minutes. When desired minutes press **SELECT** to complete the programming

CALENDAR
CLOCK

REG TIME
02:00 AM

BACKWASH
10 MIN

BRINE
01 MIN

RINSE
10 MIN

REFILL
0.0 MIN

Step 6 – Program the Valve

1. Press **SETTINGS** key to advance to **TIME OF DAY**. **TIME OF DAY** will flash.
2. Press the **UP** or **DOWN** key to adjust the **TIME OF DAY**. Press & hold the **UP** or **DOWN** key to quickly advance the hour and minutes. When desired time is displayed press **SELECT** to advance to the **REGEN DAYS** setting. **REGEN DAYS** will flash.
3. Press **SELECT** to complete pro-gramming. Now you will notice that two screens below will alternate. Time and Reg Days

TIME
08:27 AM

REG. DAYS
03

TIME
08:27 AM

REMAIN
DAYS 03

Follow the Instruction Manual to Complete the Installation of the Product